

A INTRODUCTION & PARTS

Following are the recommended instructions to safely secure three-wheeled scooters during transit. We highly recommend that scooter occupants transfer to a bus seat whenever possible. Each transporter should establish a local policy concerning the transportation of three-wheeled scooters.

The "Tri-Wheeler Kit" (Q5-7583-A) consists of a front and rear belt, as shown in **FIG. 1**. These belts help prevent damage to the scooter panels.

These belts are used with a 4-point wheelchair securement kit and a third, rear wheelchair securement hook (as detailed in the following steps).

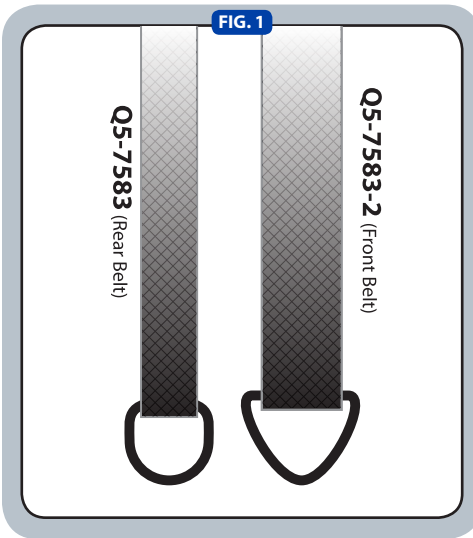

B SECURE SCOOTER: FRONT

1. Insert the two front wheelchair securements into the two inside tracks, as shown in **FIG. 2**. Turn the power OFF and ensure the wheels are locked.
2. Place the two front securements in the two inside tracks or approximately 13" – 15" apart, as shown in **FIG. 3**.
3. Place the Q5-7583-2 front belt as low as possible around the scooter steering support, as shown in **FIG. 4**.
4. Attach the hooks on the front wheelchair securements to the two rings on the scooter strap, as shown in **FIG. 4**. Adjust the tension of the securement according to the instructions provided with that product.

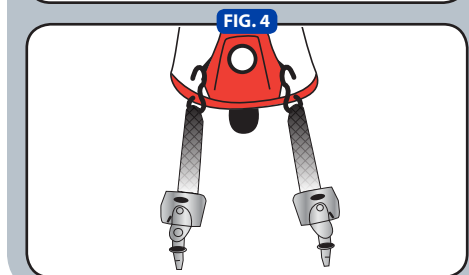
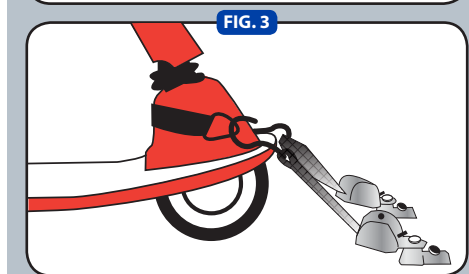
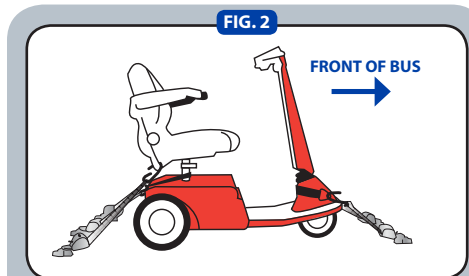

C SECURE SCOOTER: BACK

1. Insert the two rear wheelchair securements into the widest tracks on the floor or approximately 26" – 32" apart, as shown in **FIG. 5**.
2. Attach the hooks on the rear wheelchair securements to the seat frame, as shown in **FIG. 5** and **FIG. 6**.
3. Place the Q5-7583 rear belt around the scooter seat post and secure the two rings with the additional third, rear wheelchair securement hook, as shown in **FIG. 5**.
4. Unlock the wheels. Adjust the tension on the wheelchair securements according to the instructions provided with that product.

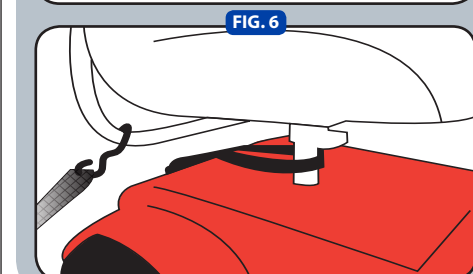
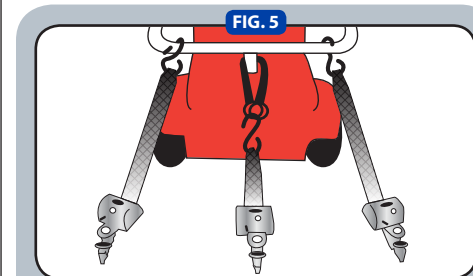

D SECURE THE PASSENGER

If the wheelchair passenger is unable or does not wish to transfer to a vehicle fixed seat, then lap and shoulder belts must be used.

1. To attach the **lap belt**, use the integrated stiffeners to feed the belts through an opening or the armrests to ensure a proper fit around the occupant.
2. On the **aisle side**, attach the belt with the female buckle to the rear securement pin connector, as shown in **FIG. 7-a**. Ensure the buckle rests on the passenger's hip.
3. On the **window side**, attach the belt with the male tongue to rear securement pin connector, as shown in **FIG. 7-a**. Insert into the female buckle, as shown in **FIG. 7-b**.
4. To attach the **shoulder belt**, extend the belt over the passenger's shoulder and across the upper torso. Then fasten the pin connector onto the lap belt, as shown in **FIG. 7-b**.

Note:

Combination lap/shoulder belts serve as both a window-side lap belt and a shoulder belt. Ensure belts are not twisted and are adjusted as firmly as possible, consistent with passenger comfort. Occupant belts should always bear upon the bony structures of the passenger's body. Belts should be worn low across the front of the pelvis so that the lap and shoulder belt junction is located near the passenger's hip.

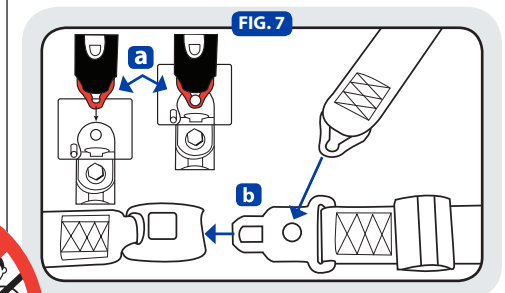

Warning: Restraints should not be held away from the body by wheelchair components or parts such as armrests, side panels or other devices, as shown in **FIG. 8**.

Have questions?
We're here to help!
(800) 987-9987